

INSTRUMENTS AND ACCESSORIES FOR CRYO SURGERY

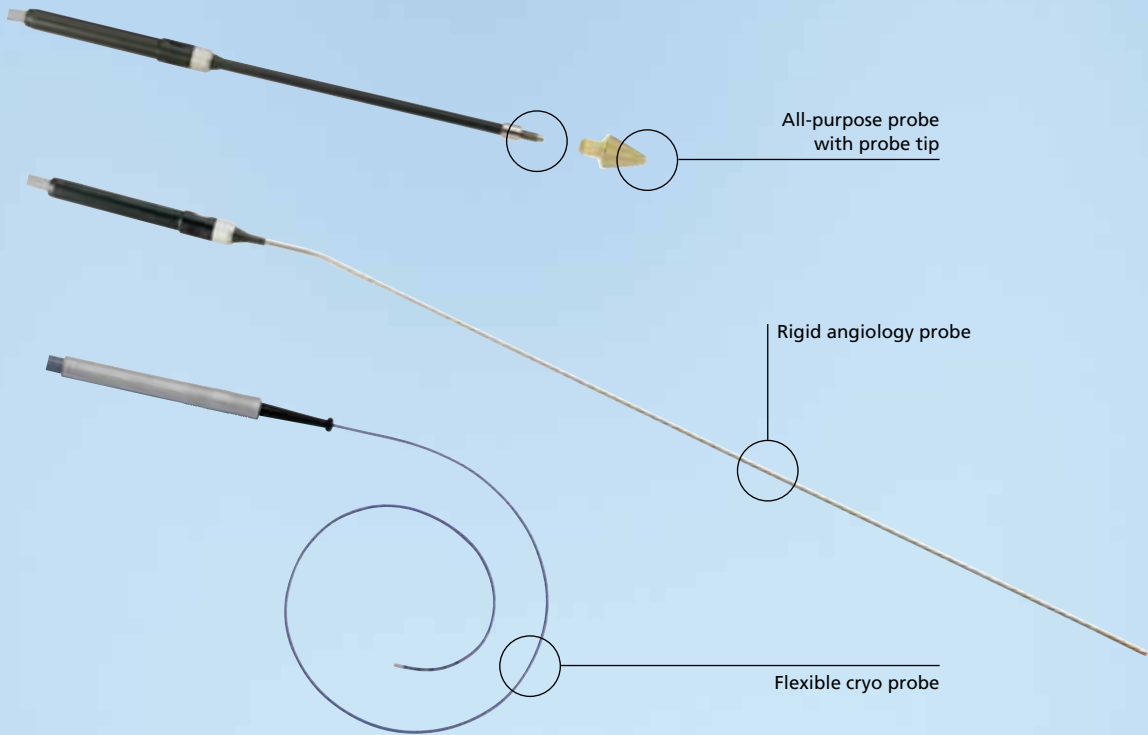

Important notes

The authors and ERBE Elektromedizin GmbH have taken the greatest possible care while compiling the catalogue with electrosurgical accessories. Nevertheless, it is impossible to exclude the possibility that errors may be contained herein.

The information and recommendations given here may not be construed as constituting any basis for any claims against ERBE Elektromedizin GmbH. Should legal regulations stipulate liability, such liability shall be limited to intentional misconduct or gross negligence.

The data on the use of instruments is based on clinical experience. Medical science is subject to a process of permanent change based on research and clinical experience. Therefore the products are subject to alterations in design and technique. Because of production tolerances dimensions in the catalogue may marginally differ.

We confirm that none of our products contain latex, except the rubber straps, Art. No. 20592-009 and 20592-011.

Please read carefully the corresponding notes on use before using any instrument.

Further product information

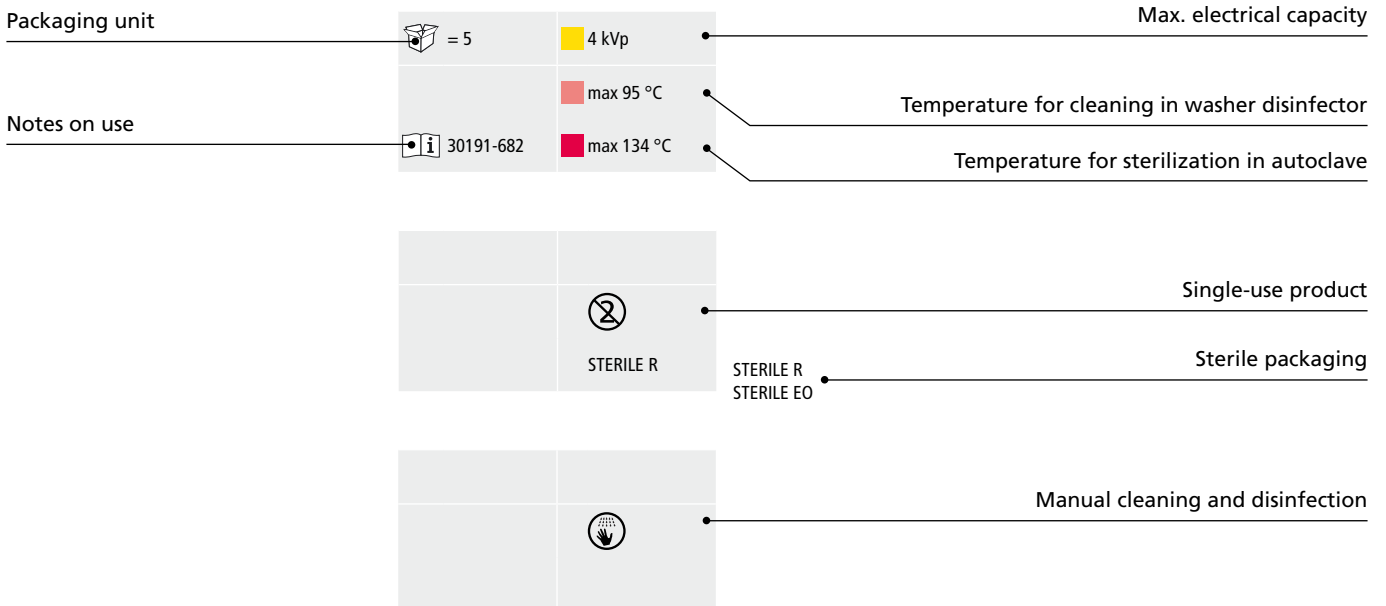

Cryo surgery

Instruments and accessories

Cryo probes for ERBOKRYO CA	04
Probe tips for ERBOKRYO CA	08
Cryo probes for ERBOKRYO AE	11
Probe tips for ERBOKRYO 12	15
Applicators for ERBOKRYO DERM	18

Overview

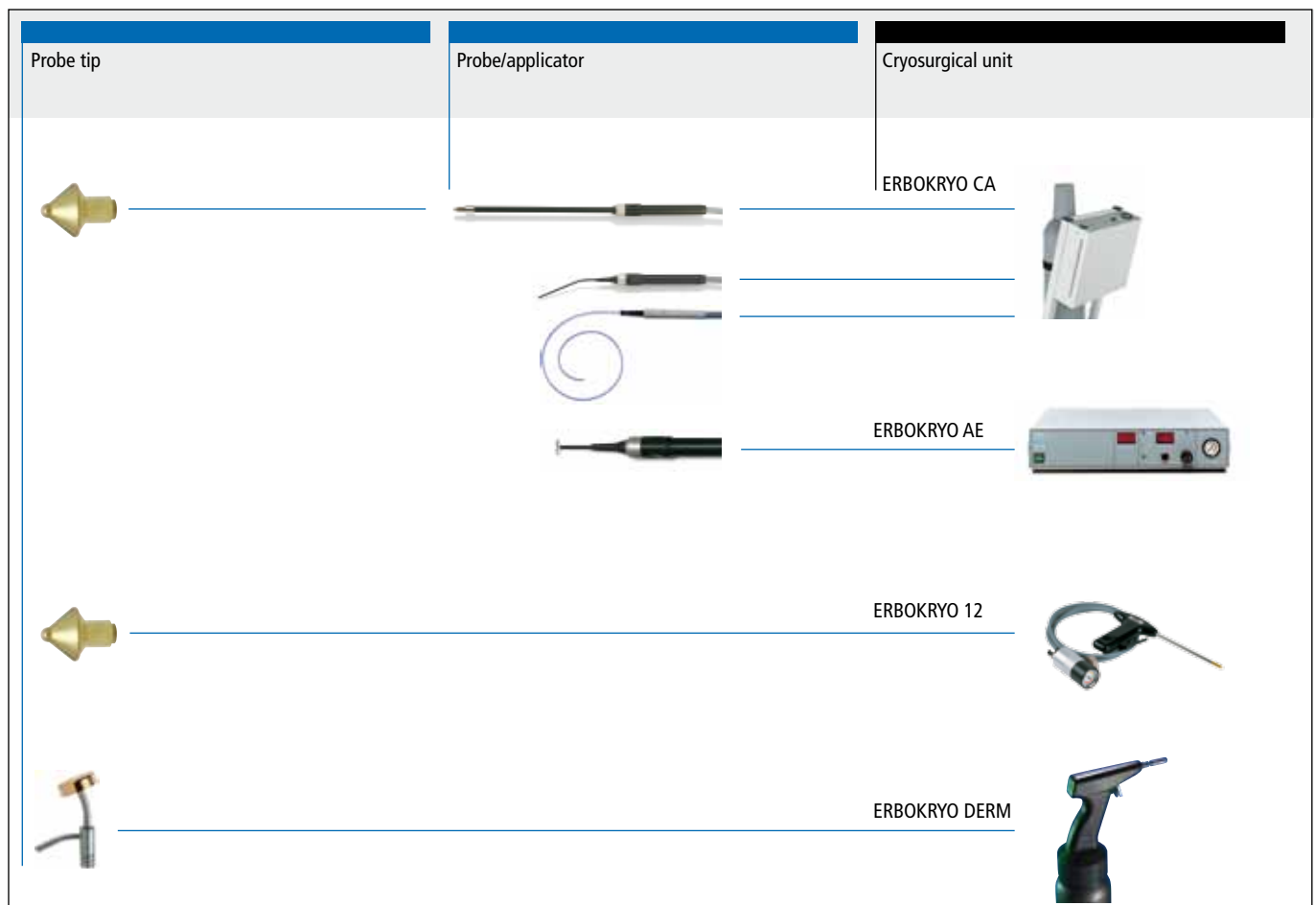

Instruments and accessories

Cryo probes for ERBOKRYO CA

Cryoprobe R4L5



e.g. for ENT

No. 20416-000

= 1



30416-058

max 134 °C

Cryoprobe R3L5



e.g. for ENT

No. 20416-001

= 1



30416-058

max 134 °C

Cryoprobe R2L2



e.g. for ENT

No. 20416-002

= 1



30416-058

max 134 °C

Cryoprobe F11



e.g. for ENT

No. 20416-003

= 1



30416-058

max 134 °C

Cryoprobe R5L10



e.g. for ENT

No. 20416-004

= 1



30416-058

max 134 °C

Cryo probes for ERBOKRYO CA

Cryoanalgesia probe, trocar, angled, Ø 0.3 mm



e.g. for spine surgery

No. 20446-003

= 1



30416-058

max 134 °C

Angiology probe, Ø 1.5 mm, length 80 mm



for cryostripping

No. 20447-000

= 1



30416-058

max 134 °C

Angiology probe, Ø 2.5 mm, length 200 mm



for cryostripping

No. 20447-002

= 1



30416-058

max 134 °C

Angiology probe, Ø 3.5 mm, length 550 mm



for cryostripping

No. 20447-004

= 1



30416-058

max 134 °C

Bronchoscopy probe, Ø 3 mm, length 530 mm



for rigid bronchoscopy

No. 20447-005

= 1



30416-058

max 134 °C

Cryo probes for ERBOKRYO CA

Flexible cryo probe, Ø 2.4 mm, length 900 mm

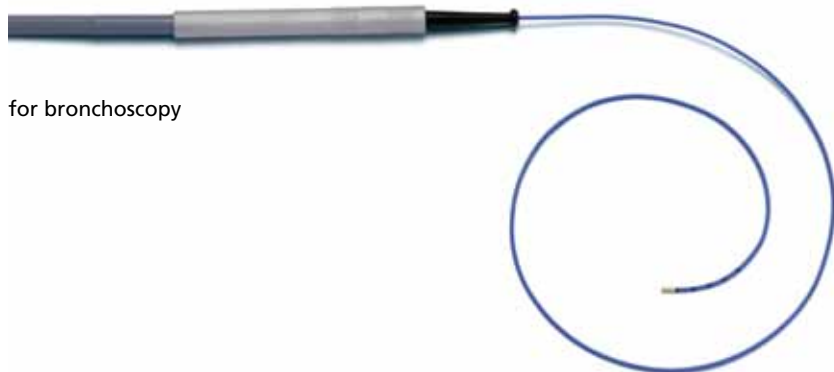

for bronchoscopy

No. 20416-032



= 1



30416-158

max 95 °C

max 134 °C

Flexible cryo probe, Ø 2.4 mm, length 780 mm

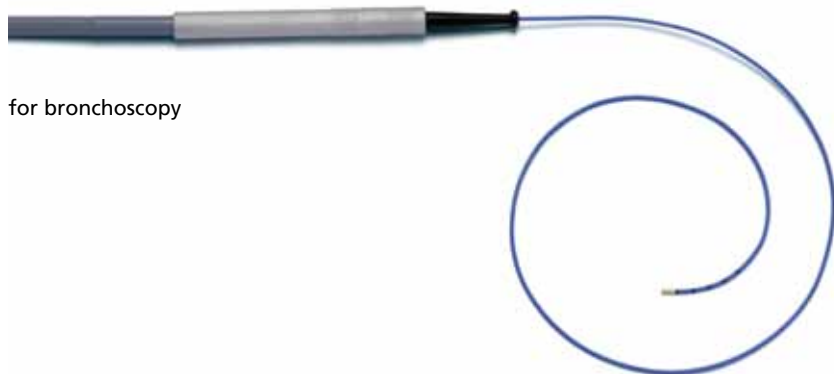

for bronchoscopy

No. 20416-033



= 1



30416-158

max 95 °C

max 134 °C

Cryo probes for ERBOKRYO CA

Flexible cryo probe, Ø 1.9 mm, length 900 mm

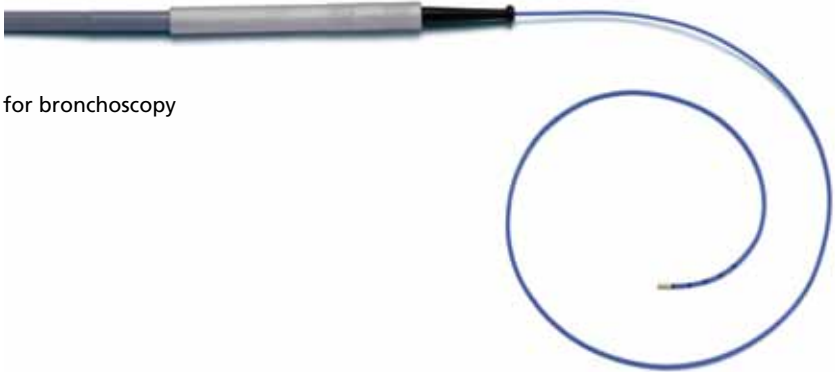

for bronchoscopy

No. 20416-037	
= 1	
	max 95 °C
30416-158	max 134 °C

Flexible cryo probe, Ø 1.9 mm, length 780 mm

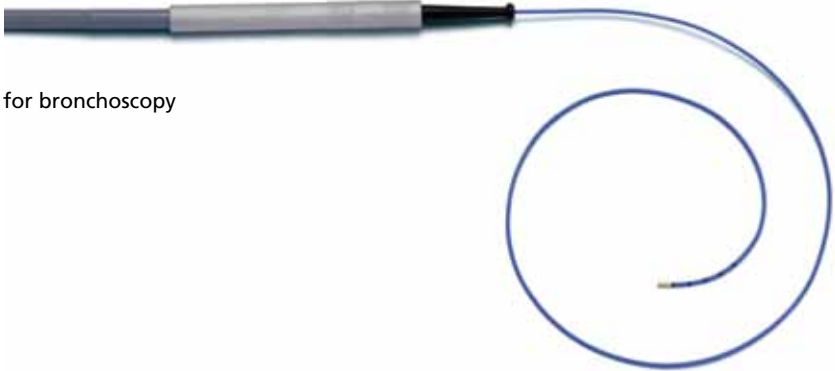

for bronchoscopy

No. 20416-038	
= 1	
	max 95 °C
30416-158	max 134 °C

Connecting adapter for flexible cryoprobes

for ERBOKRYO CA and AE



No. 20416-034	
= 1	
30416-157	

Instruments and accessories

Probe tips for ERBOKRYO CA

All purpose probe, length 180 mm



incl. tip 20420-012

No. 20416-006

= 1

30420-041



max 134 °C

All purpose probe, length 60 mm



incl. tip 20420-012

No. 20416-005

= 1

30420-041



max 134 °C

Cryoprobe tip, Ø 3 x 2.6 mm

e.g. for dermatology



No. 20420-010

= 1

30420-041

max 95 °C

max 134 °C

Cryoprobe tip, conical, Ø 9.5 mm

e.g. for dermatology



No. 20420-012

= 1

30420-041

max 95 °C

max 134 °C

Cryoprobe tip, oval, Ø 9.5 mm

e.g. for dermatology



No. 20420-013

= 1

30420-041

max 95 °C

max 134 °C

Probe tips for ERBOKRYO CA

Cryoprobe tip, Ø 19 mm



e.g. for potop ectopy

No. 20420-014



= 1



30420-041

max 95 °C

max 134 °C

Cryoprobe tip, Ø 19 mm



e.g. for potop ectopy

No. 20420-015



= 1



30420-041

max 95 °C

max 134 °C

Cryoprobe tip, flat, Ø 19 mm



e.g. for proctology or dermatology

No. 20420-016



= 1



30420-041

max 95 °C

max 134 °C

Cryoprobe tip, Ø 19 mm



e.g. for potop ectopy

No. 20420-020



= 1



30420-041

max 95 °C

max 134 °C

Cryoprobe tip, Ø 21 mm



e.g. for potop ectopy

No. 20420-021



= 1



30420-041

max 95 °C

max 134 °C

Instruments and accessories

Probe tips for ERBOKRYO CA

Cryoprobe tip, Ø 23 mm



e.g. for potop ectopy

No. 20420-022



= 1



30420-041

max 95 °C

max 134 °C

Cryoprobe tip, Ø 25 mm



e.g. for potop ectopy

No. 20420-023



= 1



30420-041

max 95 °C

max 134 °C

Cryoprobe tip, Ø 18 mm



e.g. for potop ectopy

No. 20420-024



= 1



30420-041

max 95 °C

max 134 °C

Accessories for ERBOKRYO CA

No.

One pedal foot switch, explosion-proof	20711-008
One pedal foot switch, non explosion-proof	20711-009
Cylinder cover for N ₂ O cylinders (german standard)	20410-039
Sterilizing box for cryo probes, small	20410-034
Sterilizing box for cryo probes, large	20410-035
Gas hose N ₂ O, length 0.7 m	20448-000
Gas filter N ₂ O (R 3/8")	20410-006
Gas hose CO ₂ , length 1 m	20410-004
Gas filter for CO ₂ (W 21,8 x 1/14")	20410-010
Filter cartridges (set)	20410-008
Gas cylinder connector for N ₂ O (german standard)	20410-001
Gas cylinder connector (UK, Greece) (11/16" x 20)	20410-002
Gas cylinder connector for CO ₂ (german standard)	20410-003
Gas cylinder connector (GB, F, USA) pin index 3+5 for N ₂ O	20410-005
Gas cylinder connector (GUS) M 22 x 1,5	20410-013
Gas cylinder connector (Russia) for CO ₂ (M 26 x 1,5)	20410-016
Gas cylinder connector (GB, F, USA) pin index 1+6 for CO ₂	20410-011
Gas cylinder connector (CGA) 326 (G1/2")	20410-014
Gas cylinder connector (F) (M 26 x 1,5)	20410-037
Handle for all purpose probes	20416-007

Cryoprobes for ERBOKRYO CA and AE

Cataract-pencil, straight, Ø 1.9 mm



with thermocouple

No. 20711-080

= 1

30711-150



max 134 °C

Cataract- pencil, curved, Ø 1.9 mm



with thermocouple

No. 20711-081

= 1

30711-150



max 134 °C

Retina-pencil, ball, Ø 2.5 mm



with thermocouple

No. 20711-082

= 1

30711-150



max 134 °C

Retina-pencil, spatula, 7 mm



with thermocouple

No. 20711-083

= 1

30711-150



max 134 °C

Retina-pencil, T-shaped, 10 mm



with thermocouple

No. 20711-084

= 1

30711-150



max 134 °C

Retina-pencil, long, ball, Ø 2.5 mm



with thermocouple

No. 20711-085

= 1

30711-150



max 134 °C

Instruments and accessories

Cryoprobes for ERBOKRYO CA and AE

Glaucoma-pencil, Ø 3 mm



with thermocouple

No. 20711-087

= 1

30711-150



max 134 °C

Retina-pencil, for infants, Ø 1.6 mm



with thermocouple

No. 20711-088

= 1

30711-150



max 134 °C

Retina-pencil, ball, Ø 3 mm, 90°



with thermocouple

No. 20711-089

= 1

30711-150



max 134 °C

Trichiasis-pencil, 4 x 10 mm



with thermocouple

No. 20711-090

= 1

30711-150



max 134 °C

Retina-pencil, ball, Ø 2.5 mm, 60°



with thermocouple

No. 20711-091

= 1

30711-150



max 134 °C

Retina-pencil, ball, Ø 2.7 mm, 60°



with thermocouple

No. 20711-092

= 1

30711-150



max 134 °C

Cryoprobes for ERBOKRYO CA and AE

Cataract-pencil, straight, Ø 1.5 mm



without thermocouple

No. 20716-080

= 1

30711-150



max 134 °C

Cataract-pencil, curved, Ø 1.5 mm



without thermocouple

No. 20716-081

= 1

30711-150



max 134 °C

Retina-pencil, ball, Ø 2.5 mm



without thermocouple

No. 20716-082

= 1

30711-150



max 134 °C

Retina-pencil, spatula, 7 mm



without thermocouple

No. 20716-083

= 1

30711-150



max 134 °C

Retina-pencil, T-shaped, 10 mm



without thermocouple

No. 20716-084

= 1

30711-150



max 134 °C

Retina-pencil, long, ball, Ø 2.5 mm



without thermocouple

No. 20716-085

= 1

30711-150



max 134 °C

Cryoprobes for ERBOKRYO CA and AE

Intravitreal-pencil, Ø 1.3 mm



without thermocouple

No. 20716-086



30711-150



max 134 °C

Glaucoma-pencil, Ø 3 mm



without thermocouple

No. 20716-087



30711-150



max 134 °C

Endocryo-pencil, Ø 1 mm



without thermocouple

No. 20716-088



30711-150



max 134 °C

Accessories for ERBOKRYO AE	No.
Trolley, 57 x 99 x 62 mm (W x H x D)	20731-007
Drawer for trolley	20731-010
Foot switch, explosion-proof	20711-008
Foot switch, non explosion-proof	20711-009
Cylinder cover for N ₂ O cylinders (german standard)	20410-039
Sterilizing box for cryo probes, small	20410-034
Sterilizing box for cryo probes, large	20410-035
Gas hose N ₂ O, length 0.7 m	20448-000
Gas filter N ₂ O (R 3/8")	20410-006
Gas hose CO ₂ , length 1 m	20410-004
Gas filter for CO ₂ (W 21,8 x 1/14")	20410-010
Filter cartridges (set)	20410-008
Gas cylinder connector for N ₂ O (german standard)	20410-001
Gas cylinder connector (UK, Greece) (11/16" x 20)	20410-002
Gas cylinder connector for CO ₂ (german standard)	20410-003
Gas cylinder connector (GB, F, USA) pin index 3+5 for N ₂ O	20410-005
Gas cylinder connector (GUS) M 22 x 1,5	20410-013
Gas cylinder connector (Russia) for CO ₂ (M 26 x 1,5)	20410-016
Gas cylinder connector (GB, F, USA) pin index 1+6 for CO ₂	20410-011
Gas cylinder connector (CGA) 326 (G1/2")	20410-014
Gas cylinder connector (F) (M 26 x 1,5)	20410-037

Probe tips for ERBOKRYO 12

Cryoprobe tip, Ø 3 x 2.6 mm



e.g. for dermatology

No. 20420-010



= 1



30420-041

max 95 °C

max 134 °C

Cryoprobe tip, conical, Ø 9.5 mm



e.g. for dermatology

No. 20420-012



= 1



30420-041

max 95 °C

max 134 °C

Cryoprobe tip, oval, Ø 9.5 mm



e.g. for dermatology

No. 20420-013



= 1



30420-041

max 95 °C

max 134 °C

Cryoprobe tip, Ø 19 mm



e.g. for potop ectopy

No. 20420-014



= 1



30420-041

max 95 °C

max 134 °C

Cryoprobe tip, Ø 19 mm



e.g. for potop ectopy

No. 20420-015



= 1



30420-041

max 95 °C

max 134 °C

Probe tips for ERBOKRYO 12

Cryoprobe tip, flat, Ø 19 mm



e.g. for proctology or dermatology

No. 20420-016

= 1

30420-041

max 95 °C

max 134 °C

Cryoprobe tip, Ø 19 mm



e.g. for potop ectopy

No. 20420-020

= 1

30420-041

max 95 °C

max 134 °C

Cryoprobe tip, Ø 21 mm



e.g. for potop ectopy

No. 20420-021

= 1

30420-041

max 95 °C

max 134 °C

Cryoprobe tip, Ø 23 mm



e.g. for potop ectopy

No. 20420-022

= 1

30420-041

max 95 °C

max 134 °C

Cryoprobe tip, Ø 25 mm



e.g. for potop ectopy

No. 20420-023

= 1

30420-041

max 95 °C

max 134 °C

Cryoprobe tip, Ø 18 mm



e.g. for potop ectopy

No. 20420-024

= 1



30420-041

 max 95 °C

 max 134 °C

Gas cylinder connectors and further accessories	No.
Gas filter N ₂ O (R 3/8")	20410-006
Gas filter for CO ₂ (W 21,8 x 1/14")	20410-010
Gas cylinder connector for N ₂ O (german standard)	20410-001
Gas cylinder connector (UK, Greece) (11/16" x 20)	20410-002
Gas cylinder connector für CO ₂ (german standard)	20410-003
Gas cylinder connector (F) (M 26 x 1,5)	20410-037
Gas cylinder connector G 1/2"	20410-014
Gas cylinder connector (GUS) M 22 x 1,5	20410-013
Gas cylinder connector (GB, F, USA) pin index 3+5 for N ₂ O	20410-005
Gas cylinder connector (Russia) for CO ₂ (M 26 x 1,5)	20410-016
Gas cylinder connector (GB, F, USA) pin index 1+6 for CO ₂	20410-011
Filter cartridges (set)	20410-008
Trolley with bracket	20420-007
Wall mount support for gas cylinder and cryo gun	20420-030
Cylinder cover for N ₂ O cylinders (german standard)	20410-039

Applicators for ERBOKRYO DERM

Set of spray nozzles



contains 5 spray applicators with diameters:
0,4 mm, 0,6 mm, 0,8 mm, 1,0 mm, 1,2 mm

No. 20475-002

= 5

max 95 °C

30475-023

max 134 °C

Contact applicator, Ø 20 mm



e.g. for dermatology

No. 20475-045

= 1

max 95 °C

30475-023

max 134 °C

Contact applicator, Ø 1.5 mm



e.g. for dermatology

No. 20475-046

= 1

max 95 °C

30475-023

max 134 °C

Contact applicator, Ø 2 mm



e.g. for dermatology

No. 20475-047

= 1

max 95 °C

30475-023

max 134 °C

Contact applicator, Ø 5 mm



e.g. for dermatology

No. 20475-048

= 1

max 95 °C

30475-023

max 134 °C

Contact applicator, Ø 5 mm



e.g. for dermatology

No. 20475-049

= 1

max 95 °C

30475-023

max 134 °C

Applicators for ERBOKRYO DERM

Contact applicator, Ø 10 mm



e.g. for dermatology

No. 20475-053

= 1

max 95 °C

30475-023

max 134 °C

Contact applicator, 5 x 8 mm



e.g. for dermatology

No. 20475-056

= 1

max 95 °C

30475-023

max 134 °C

Contact applicator, Ø 15 mm



e.g. for dermatology

No. 20475-057

= 1

max 95 °C

30475-023

max 134 °C

Contact applicator, Ø 10 mm



e.g. for dermatology

No. 20475-070

= 1

max 95 °C

30475-023

max 134 °C

Accessories for ERBOKRYO DERM

No.

Refill system

20477-010

LN2-container, 30 liters

20477-011

Cart for LN2-container, 30 liters

20477-012

ELECTROSURGERY
VESSEL SEALING
ARGON PLASMA COAGULATION
CRYO SURGERY
WATERJET SURGERY

ERBE Elektromedizin GmbH
Waldhoernlestrasse 17
72072 Tuebingen
Germany
Phone +49 7071 755-0
Fax +49 7071 755-179
info@erbe-med.com
www.erbe-med.com



ERBE

Perfection for Life